

## 7/8" Mini-Receptacle Connectors, Front Mount, IEC Color Code

RSF.../11 | RSF.../13.5 | RKF.../11 | RKF.../13.5



### Male, 2-, 3-, 4-, and 5-Pole

Receptacle connector, 7/8"-A body, male 2-, 3-, 4-, and 5-pole for front mounting, assembled stranded wire, potted with epoxy, chassis side thread PG11 or PG13.5, screw connection (panel nut RSKF 11 or RSKF 13.5).

#### RSF.../11

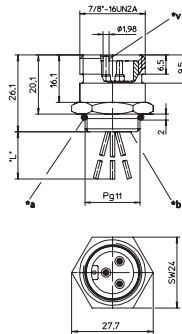

\*a O-ring enclosed separately  
\*b solder contacts potted with epoxy  
\*L 0.3 m

#### RSF.../13.5

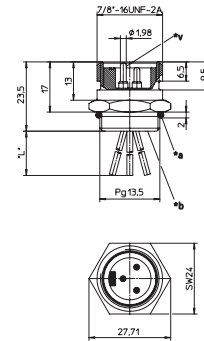

\*a O-ring enclosed separately  
\*b solder contacts potted with epoxy  
\*V center contact leading  
\*L 0.3 m



### Female, 2-, 3-, 4-, and 5-Pole

Receptacle connector, 7/8"-A body, female 2-, 3-, 4-, and 5-pole for front mounting, assembled stranded wire, potted with epoxy, chassis side thread PG11 or PG13.5, screw connection (panel nut RSKF 11 or RSKF 13.5).

#### RKF.../11

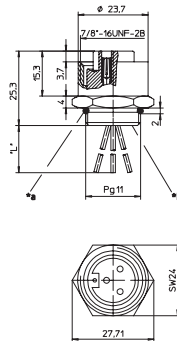

\*a O-ring enclosed separately  
\*b solder contacts potted with epoxy  
\*L 0.3 m

#### RKF.../13.5

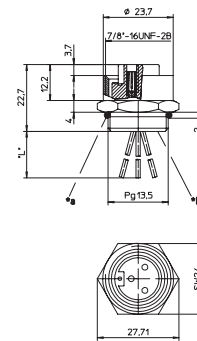

\*a O-ring enclosed separately  
\*b solder contacts potted with epoxy  
\*L 0.3 m

### Pin Assignments

#### Face Views, 7/8"-Male / Female

##### 2 pole

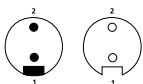

1 = brown  
2 = blue

##### 3 pole

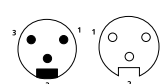

1 = brown  
2 = green/yellow (RSF...01)  
black (RSF...05)  
3 = blue

##### 4 pole

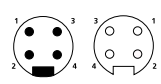

1 = brown  
2 = white  
3 = blue  
4 = black

##### 5 pole

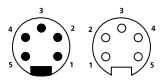

1 = black  
2 = blue  
3 = green/yellow  
4 = brown  
5 = white



Be Certain with Belden

**7/8" Mini-Receptacle Connectors, Front Mount, IEC Color Code**

RSF.../11 | RSF.../13.5 | RKF.../11 | RKF.../13.5

**Technical Data**

**Environmental**











Degree of protection IP 68 / NEMA 6P  
 Operating temperature range -25°C (-13°F) / +90°C (+194°F)

**Mechanical**

Housing / Molded body CuZn, nickel-plated  
 Insert TPU, self-extinguishing  
 Contact CuZn, silver-plated and 0.3 microns gold-plated

**Electrical**

Contact resistance ≤ 5 mΩ  
 Nominal current at 40°C 2-3 poles 12 A  
 4-5 poles 9 A  
 Nominal voltage 240 V  
 Rated voltage 250 V  
 Test voltage 3-4 poles 2.5 kV eff. / 60 s  
 5 poles 1.5 kV eff. / 60 s  
 Insulation resistance > 10<sup>9</sup> Ω  
 Pollution degree 3

Part Number				Pins	Lead (mm <sup>2</sup> )	Characteristics
Male PG11	Male PG13.5	Female PG11	Female PG13.5			
RSF 20/11-03	RSF 20/13.5-03	RKF 20/11-03	RKF 20/13.5-03	2	0.75	 
RSF 30/11-01	RSF 30/13.5-01	RKF 30/11-01	RKF 30/13.5-01	3	0.75	 
RSF 30/11-05	RSF 30/13.5-05	RKF 30/11-05	RKF 30/13.5-05		0.75	 
RSF 40/11-02	RSF 40/13.5-02	RKF 40/11-02	RKF 40/13.5-02	4	0.5	 
RSF 50/11-04	RSF 50/13.5-04	RKF 50/11-04	RKF 50/13.5-04	5	0.5	 

Receptacles