

7/8" Mini-Receptacle Connectors, Front Mount, IEC Color Code

RSF.../11 | RSF.../13.5 | RKF.../11 | RKF.../13.5



Male, 2-, 3-, 4-, and 5-Pole

Receptacle connector, 7/8"-A body, male 2-, 3-, 4-, and 5-pole for front mounting, assembled stranded wire, potted with epoxy, chassis side thread PG11 or PG13.5, screw connection (panel nut RSKF 11 or RSKF 13.5).

RSF.../11

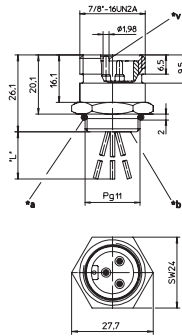

*a O-ring enclosed separately
 *b solder contacts potted with epoxy
 *L 0.3 m

RSF.../13.5

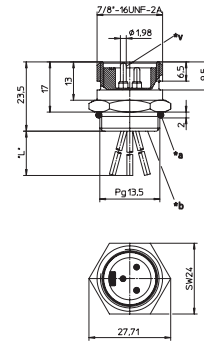

*a O-ring enclosed separately
 *b solder contacts potted with epoxy
 *v center contact leading
 *L 0.3 m



Female, 2-, 3-, 4-, and 5-Pole

Receptacle connector, 7/8"-A body, female 2-, 3-, 4-, and 5-pole for front mounting, assembled stranded wire, potted with epoxy, chassis side thread PG11 or PG13.5, screw connection (panel nut RSKF 11 or RSKF 13.5).

RKF.../11

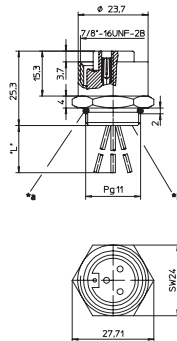

*a O-ring enclosed separately
 *b solder contacts potted with epoxy
 *L 0.3 m

RKF.../13.5

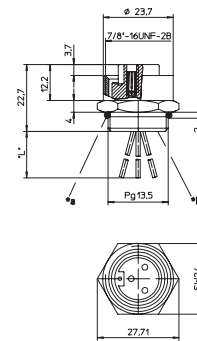

*a O-ring enclosed separately
 *b solder contacts potted with epoxy
 *L 0.3 m

Pin Assignments

Face Views, 7/8"-Male / Female

2 pole

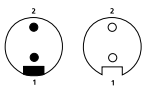

1 = brown
 2 = blue

3 pole

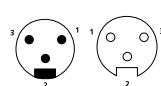

1 = brown
 2 = green/yellow (RSF...01)
 black (RSF...05)
 3 = blue

4 pole

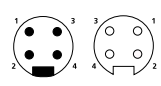

1 = brown
 2 = white
 3 = blue
 4 = black

5 pole

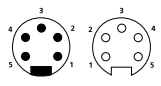

1 = black
 2 = blue
 3 = green/yellow
 4 = brown
 5 = white



Be Certain with Belden

7/8" Mini-Receptacle Connectors, Front Mount, IEC Color Code

RSF.../11 | RSF.../13.5 | RKF.../11 | RKF.../13.5

Technical Data

Environmental











Degree of protection IP 68 / NEMA 6P
 Operating temperature range -25°C (-13°F) / +90°C (+194°F)

Mechanical

Housing / Molded body CuZn, nickel-plated
 Insert TPU, self-extinguishing
 Contact CuZn, silver-plated and 0.3 microns gold-plated

Electrical

Contact resistance ≤ 5 mΩ
 Nominal current at 40°C 2-3 poles 12 A
 4-5 poles 9 A
 Nominal voltage 240 V
 Rated voltage 250 V
 Test voltage 3-4 poles 2.5 kV eff. / 60 s
 5 poles 1.5 kV eff. / 60 s
 Insulation resistance > 10⁹ Ω
 Pollution degree 3

Part Number				Pins	Lead (mm ²)	Characteristics
Male PG11	Male PG13.5	Female PG11	Female PG13.5			
RSF 20/11-03	RSF 20/13.5-03	RKF 20/11-03	RKF 20/13.5-03	2	0.75	 
RSF 30/11-01	RSF 30/13.5-01	RKF 30/11-01	RKF 30/13.5-01	3	0.75	 
RSF 30/11-05	RSF 30/13.5-05	RKF 30/11-05	RKF 30/13.5-05		0.75	 
RSF 40/11-02	RSF 40/13.5-02	RKF 40/11-02	RKF 40/13.5-02	4	0.5	 
RSF 50/11-04	RSF 50/13.5-04	RKF 50/11-04	RKF 50/13.5-04	5	0.5	 

Receptacles