

## M8-Receptacle Connectors In Accordance With IEC 61076-2-104

RSMEDG | RSMEDGN



### Male, 8-Pole

Receptacle connector, M8 male connector for sensors, with combined snap-in/threaded joint, mounting hole for LED, short solder contacts, hollow contacts on solder side.

RSMEDG

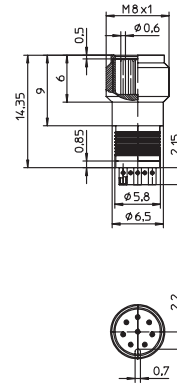

### Male, 3 and 4-Pole

Receptacle connector, M8 male connector for sensors, with housing of stainless steel, threaded joint, 4 light indicator windows, mounting hole for LED, short solder contacts, hollow contact on solder side.

RSMEDGN

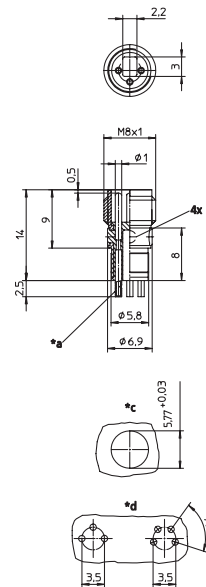

### Pin Assignments

Face Views

M8 - 3 and 4 poles

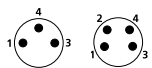

M8 - 8 poles



\*a hollow  
\*c cut out  
\*d hole pattern in printed circuit board



Be Certain with Belden

**M8-Receptacle Connectors In Accordance With IEC 61076-2-104**  
 RSMEDG | RSMEDGN

**Technical Data**

**Environmental**

Degree of protection IP 67 / NEMA 6P  
 Operating temperature range -25°C (-13°F) / +80°C (+176°F)

**Mechanical**

Housing / Molded body CuZn, nickel-plated  
 Insert PA  
 Contact CuZn, pre-nickeled and 0.8 microns gold-plated  
 Mode of connection solder connection  
 Connectable conductor max. 0.14 mm<sup>2</sup>

**Electrical**

Contact resistance ≤ 5 mΩ  
 Nominal current at 40°C 1.5 A  
 Nominal voltage 30 V  
 Test voltage 0.5 kV eff. / 60 s  
 Insulation resistance > 10<sup>9</sup> Ω  
 Pollution degree 3

Receptacles

Part Number	Pins	Contact (soldering side)	Characteristics
RSMEDGN 3	3		
RSMEDGN 4	4		
RSMEDG 8	8	hollow contact	