

## M8-Receptacle Connectors In Accordance With IEC 61076-2-104

### RSME | RSMEK | RSMEK...L



#### Male, 3- and 4-Pole

Receptacle connector, M8 male connector for sensors, with long solder contacts, solid contacts on solder side.

#### RSME

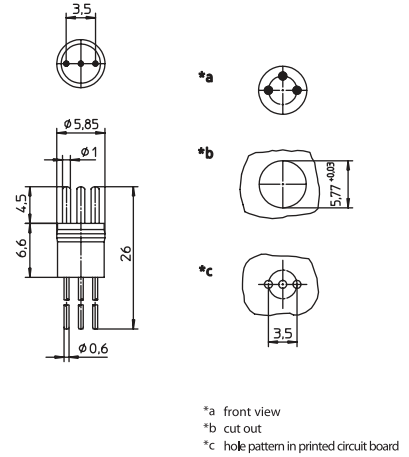

#### Male, 3- and 4-Pole

Receptacle connector, M8 male connector for sensors, with short solder contacts, solid contacts on solder side, RSMEK...L: with ventilation hole 1.1 mm Ø.

#### RSMEK | RSMEK...L

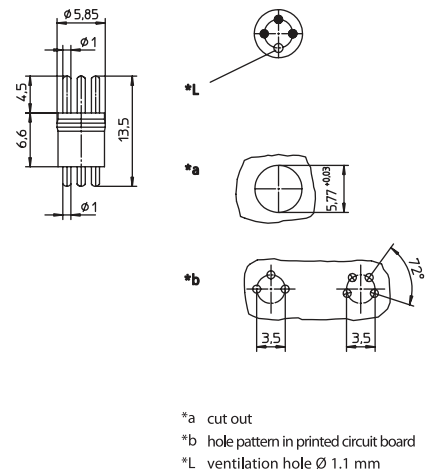

### Pin Assignments

#### Face Views

#### M8 - 3 and 4 poles

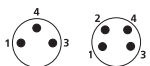



**M8-Receptacle Connectors In Accordance With IEC 61076-2-104**  
RSME | RSMEK | RSMEK...L

**Technical Data**

**Environmental**  
Degree of protection IP 67 / NEMA 6P  
Operating temperature range -25°C (-13°F) / +80°C (+176°F)

**Mechanical**  
Insert PA  
Contact CuZn, pre-nickel and 0.8 microns gold-plated

**Electrical**  
Contact resistance  $\leq 5 \text{ m}\Omega$   
Nominal current at 40°C 4 A  
Nominal voltage 60 V  
Rated voltage 63 V  
Test voltage 1.5 kV eff. / 60 s  
Insulation resistance  $> 10^9 \Omega$   
Pollution degree 3

Part Number	Pins	Ventilation hole	Contact (soldering side)	Characteristics
RSME 3	3		solid contact	
RSMEK 3L		1.1 mm Ø	solid contact	
RSMEK 4	4		solid contact	